

# Meeting and event spaces



Space	Dimensions	Square feet	Ceiling height	Reception	Rounds of 10	Classroom 3 per 8'	Hollow sq/conf	U-shape	Theater style	8'x10' trade show booth	10'x10' trade show booth
<b>SentryWorld</b>											
Grand Hall	76' x 58'	5,692	30'	350	370	210	72	60	380	18	15
Grand Hall Foyer	Varies	2,500	15'	250	—	—	—	—	—	—	—
Atrium	50' x 91'	4,882	22'	335	280	200	112	96	336	32	24
Fieldhouse	248' x 196'	51,354	50'	2,500	2,500	—	—	—	3,000	175	154
Fieldhouse 1, 3, 5 or 2, 4, 6	120' x 180'	21,600	50'	1,500	1,000	—	—	—	1,500	95	75
Fieldhouse 1 & 3, 2 & 4, 5 & 6	120' x 120'	14,400	50'	1,000	850	650	—	—	1,000	75	50
Fieldhouse 1, 2, 3, 4, 5, 6	120' x 60'	7,200	50'	500	500	342	—	—	750	30	50
Pergola	13' x 18' base	—	10'1" to top of beams	250	100	—	—	—	350	—	—
Community Room	35' x 19'	710	12'	45	40	36	30	24	60		
PJ's Celebration Room	24' 7" X 13'	312	12'	16	—	—	16	—	—	—	—
PJ's Lounge Area	23' x 15'	350	12'	40	—	—	—	—	—	—	—
SentryWorld Outdoor Gallery Area	Accommodate up to 300 in a tent										
The Salon at SentryWorld	—	478	16'	15	—	—	—	—	—	—	—
<b>The Inn at SentryWorld</b>											
Gathering Room I & II*	25'3" x 60'4"	1,522	11'	100	90	54	48	48	100	—	—
Gathering Room I or II*	25'3" x 30'	760	11'	50	40	27	18	18	50	—	—
Gathering Foyer	14'6" x 61'7"	893	11'	60	—	—	—	—	—	—	—
The Salon at The Inn	—	390	10'	8	—	—	—	—	—	—	—

\*Gathering Room(s) are max of 8 guests per round table.

**PLEASE NOTE:** Room capacities are fire code capacities. When planning your event, please note that room capacity may decrease depending on AV production and/or catering/setup requirements.



SENTRY WORLD

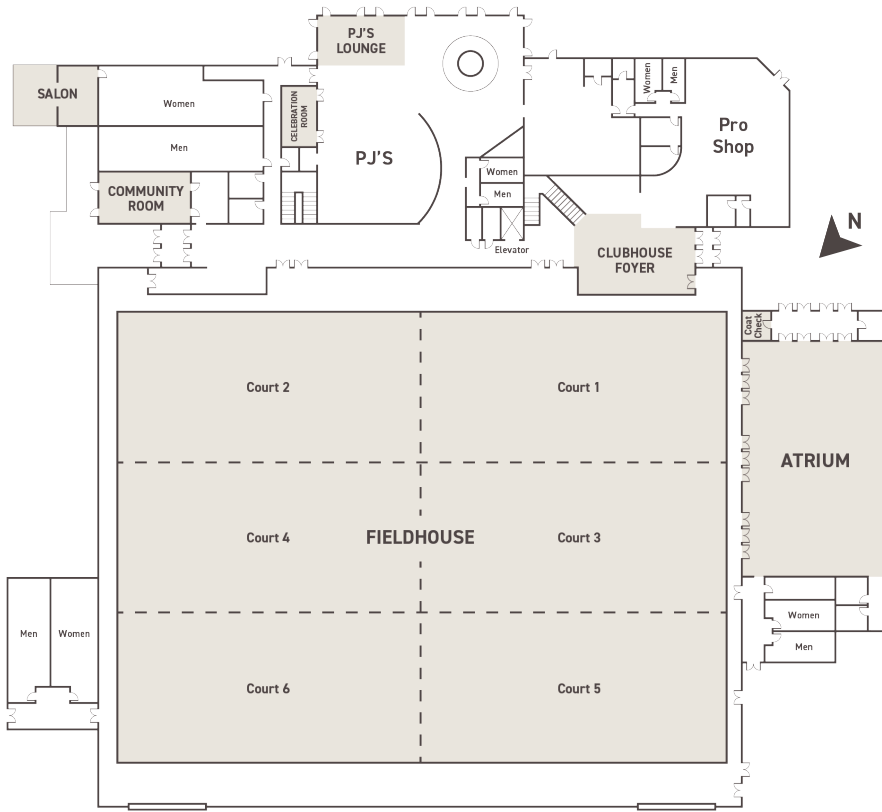

First floor

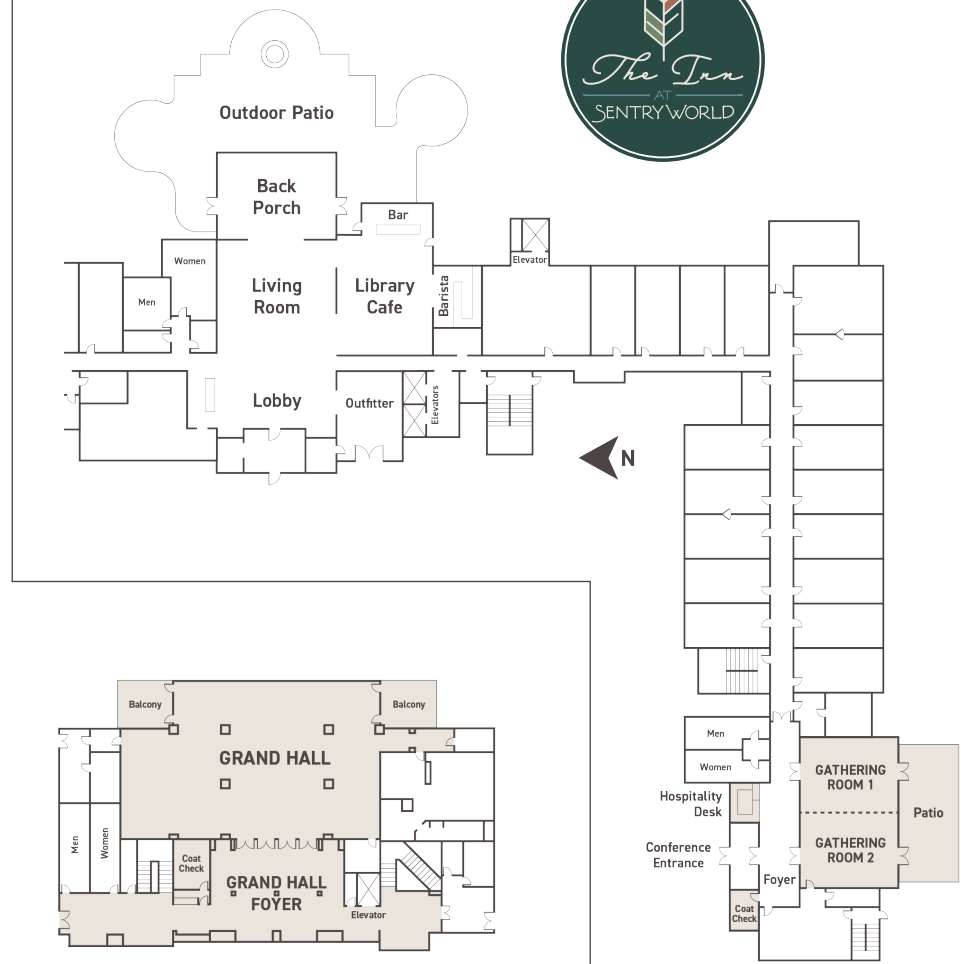

Second floor



Fieldhouse



Atrium



Grand Hall



Community Room



Gathering Room

# Meeting and event spaces

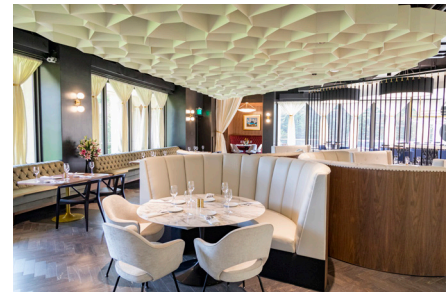
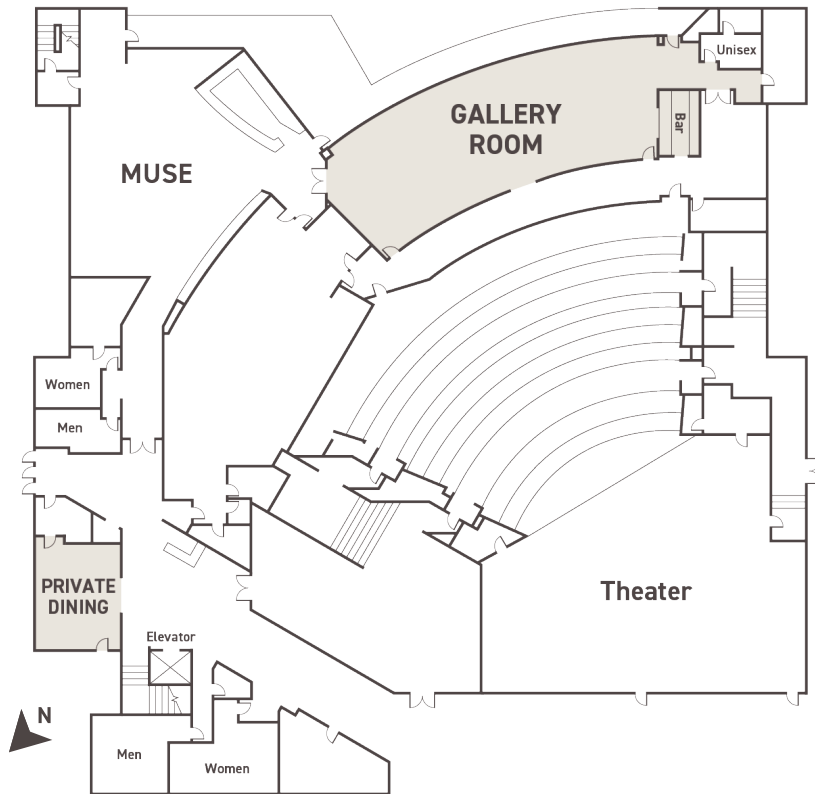

Restaurant



Bar



Gallery Room



Private Dining Room

Space	Dimensions	Square feet	Ceiling height	Reception	Rounds of 10	Classroom 3 per 8'	Hollow sq/conf	U-shape	Theater style	8'x10' trade show booth	10'x10' trade show booth
<b>Muse</b>											
Gallery Room	27' 9" x 78' 8"	2,079	14'	100	120	70	40	36	144	—	—
Private Dining Room	22' 10" x 18' 4"	433	11'	24	24	—	24	18	—	—	—

PLEASE NOTE: Room capacities are fire code capacities. When planning your event, please note that room capacity may decrease depending on AV production and/or catering/setup requirements.